

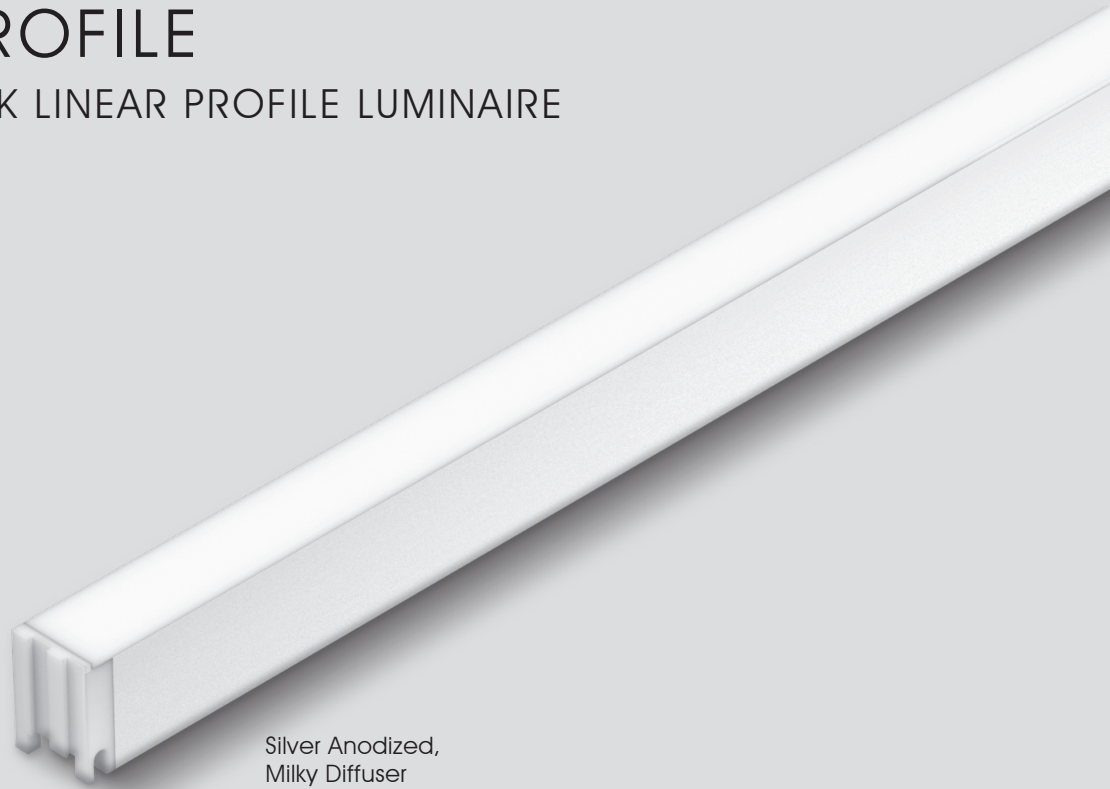

# LP13Fi PROFILE

FLAT INTERLOCK LINEAR PROFILE LUMINAIRE



Silver Anodized,  
Milky Diffuser

## PROFILE FINISHING

Silver Anodized



DIFFUSER

Milky

## DIMENSION

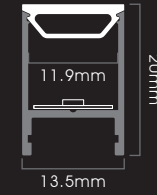

## INSTALLATION



## ACCESSORIES

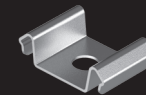

Mounting Clip

Beam Angle: 110°



- Profile Type : 13.5mm width aluminium linear profile
- Profile Finishing : Silver Anodised
- Diffuser : Milky
- Light Uniformity : Dot-less
- Mounting : Surface, with stainless steel mounting clip
- Compatible LED Module : FM6, FM8 TW, FM8 WD, FM10 WD, FM10 RGB
- CRI : Ra>90, R9>50
- SDCM : 3 step MacAdam ellipse binning
- Lifetime : Up to 50,000 hours L80 lamp life at Ta = 25°C
- Voltage : 24V DC
- Maximum Power : 15W/m
- Length Options : 113mm to 1963mm by increment of 50mm
- Operating Temperature : Ta (min) = -20°C, Ta (max) = +50°C
- Wire Connection : Supplied with insulated wires at 200mm length
- IP Rating : IP40 or IP54
- Profile LOR : 33% (Milky diffuser)

#### ☐ CCT OPTIONS

Single CCT



Tunable-White

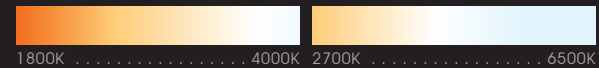

Dim-to-Warm



RGB



☐ PHOTOMETRICS

- With FM6 15W/m

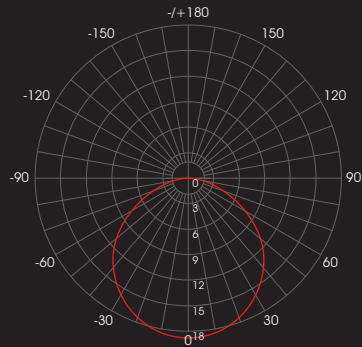

Correction Factor : FM6 5W/m ~ f = 0.33  
 FM6 10W/m ~ f = 0.67  
 FM6 15W/m ~ f = 1.00

☐ SPECIFICATIONS

- With FM6, FM8 TW, FM8 WD Module

CCT	Efficacy (lm/W)	Luminous Flux per meter (lm/m)			Diffuser Type
		5W/m	10W/m	15W/m	
<b>1800K</b> <b>2000K</b>	25.6	128	256	383	Milky
<b>2200K</b> <b>2500K</b>	30.5	152	305	457	
<b>2700K</b> <b>3000K</b> <b>3500K</b>	35.0	175	350	525	
<b>4000K</b> <b>5000K</b> <b>5700K</b> <b>6500K</b>	36.8	184	368	551	

- With FM10 WD Module

CCT	Dimming Level	Efficacy (lm/W)	Luminous Flux per meter (lm/m)	Diffuser Type
			15W/m	
<b>1800K</b>	7%	21.9	23	Milky
<b>2000K</b>	16%	24.6	59	
<b>2200K</b>	20%	27.3	82	
<b>2500K</b>	29%	31.3	136	
<b>2700K</b>	38%	34.0	194	
<b>3000K</b>	100%	38.0	570	

- With FM10 RGB Module

CCT	Efficacy (lm/W)	Diffuser Type	RGB Wavelength (nm)
<b>Red</b>	9.9	Milky	617 - 627
<b>Green</b>	19.1		515 - 525
<b>Blue</b>	4.0		464 - 474

ORDERING MATRIX

FULLY ASSEMBLED WITH FLEXIBLE LINEAR LED STRIP

Module	Finishing	Diffuser	Length	LED Module Power & CCT				Wire End & Exit Configuration	Ingress Protection
<b>LP13Fi</b>	<b>SL</b> Silver	<b>M</b> Milky	<b>113</b> 113mm ↓ ↓ <b>1963</b> 1963mm *by every 50mm	FM6	<b>5</b> 5W/m	<b>22</b>	2200K	<b>SR</b> Single Wire End, Rear Exit	<b>IP40</b> IP40 <b>IP54</b> IP54
					<b>10</b> 10W/m	<b>25</b>	2500K		
					<b>15</b> 15W/m	<b>27</b>	2700K		
						<b>30</b>	3000K		
						<b>35</b>	3500K		
						<b>40</b>	4000K		
						<b>50</b>	5000K		
						<b>57</b>	5700K		
						<b>65</b>	6500K		
					FM8 TW/WD	<b>5</b> 5W/m	<b>TW1840</b>		
<b>10</b> 10W/m	<b>TW2765</b>	Tunable-White 2700K-6500K							
<b>15</b> 15W/m	<b>WD1830</b>	Dim-to-Warm 1800K-3000K							
FM10 WD	<b>15</b> 15W/m	<b>WD1830</b>	Dim-to-Warm 1800K-3000K						
FM10 RGB	<b>10</b> 10W/m	<b>RGB</b>	RGB						
	<b>15</b> 15W/m								

Example: LP13Fi-SL-M-963-5-30-SR-IP40

LP13Fi Profile, Silver, Milky Diffuser, 963mm, with FM6 - 5W/m, 3000K, Single Wire End at Rear Exit, IP40, Including 2 x End Cap & 2 x Mounting Clip

\*Linear profiles of 113mm to 963mm length are supplied with 2 mounting clips.

\*Linear profiles of 1013mm to 1463mm length are supplied with 3 mounting clips.

\*Linear profiles of 1513mm to 1963mm are supplied with 4 mounting clips.

LINEAR PROFILE ONLY

Profile	Finishing	Diffuser	Length
<b>LP13Fi</b>	<b>SL</b> Silver	<b>M</b> Milky	<b>1000</b> 1000mm
			<b>1500</b> 1500mm
			<b>2000</b> 2000mm

Example: LP13Fi-SL-M-2000

LP13Fi Profile, Silver, Milky Diffuser, 2000mm

End Cap
<b>LP13Fi-EC</b>

Example: LP13Fi-EC

LP13Fi End Cap

Mounting Clip
<b>LP13Fi-MC</b>

Example: LP13Fi-MC

LP13Fi Mounting Clip